

THIS DRAWING IS UNPUBLISHED. RELEASED FOR PUBLICATION 2017  
 © COPYRIGHT 2017 BY - TE CONNECTIVITY ALL RIGHTS RESERVED.

REVISIONS					
P	LTR	DESCRIPTION	DATE	DWN	APVD
A1		REVISED PER ECO-19-002431	15FEB2019	BKW	GJ
A2		REVISED PER ECO-19-013371	29AUG2019	BKW	GJ
A3		REVISED PER ECR-20-100211	05AUG2020	JP	VS
B		REVISED PER ECN-25-314081	09APR2025	MMK	JHW

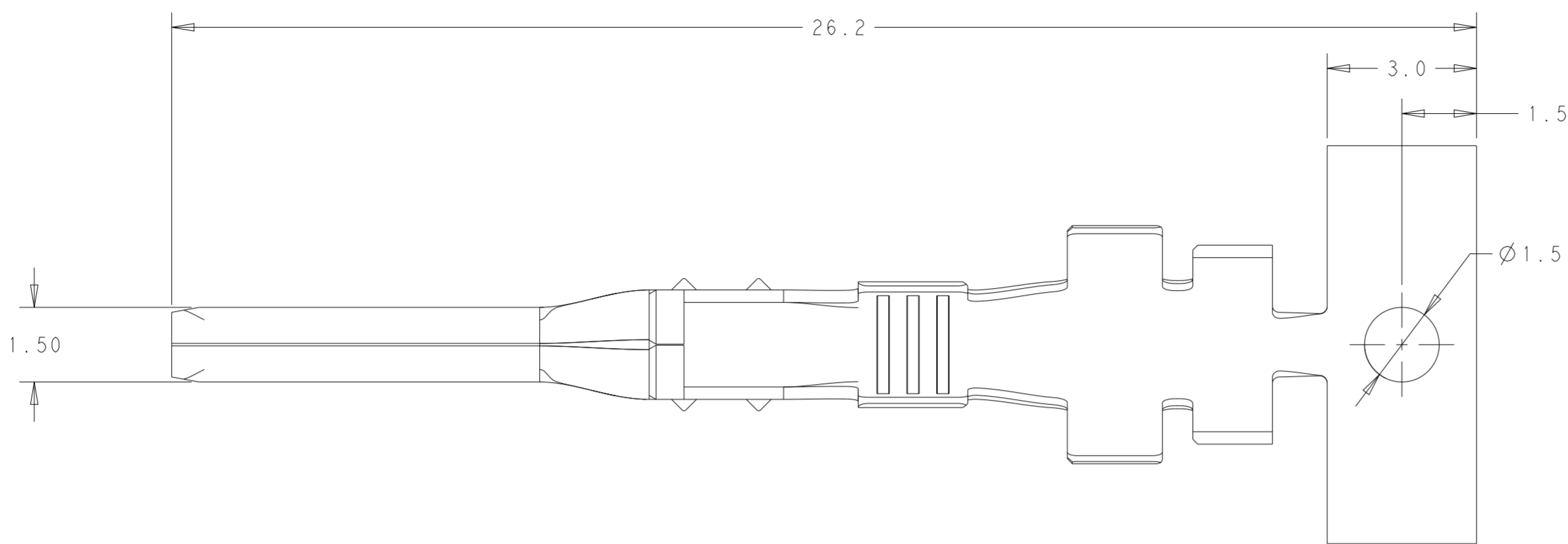

- 1 MATERIAL MARK
- 2 RECOMMENDED WIRE RANGE:  
18-20 AWG COPPER STRANDED &  
2x22 AWG COPPER STRANDED
- 3 INSULATION DIAMETER RANGE:  
18-20 AWG - 1.7~2.8  
2x22 AWG - 1.6~2.3
- 4 SUPPLIED CONTINUOUS ON A REEL

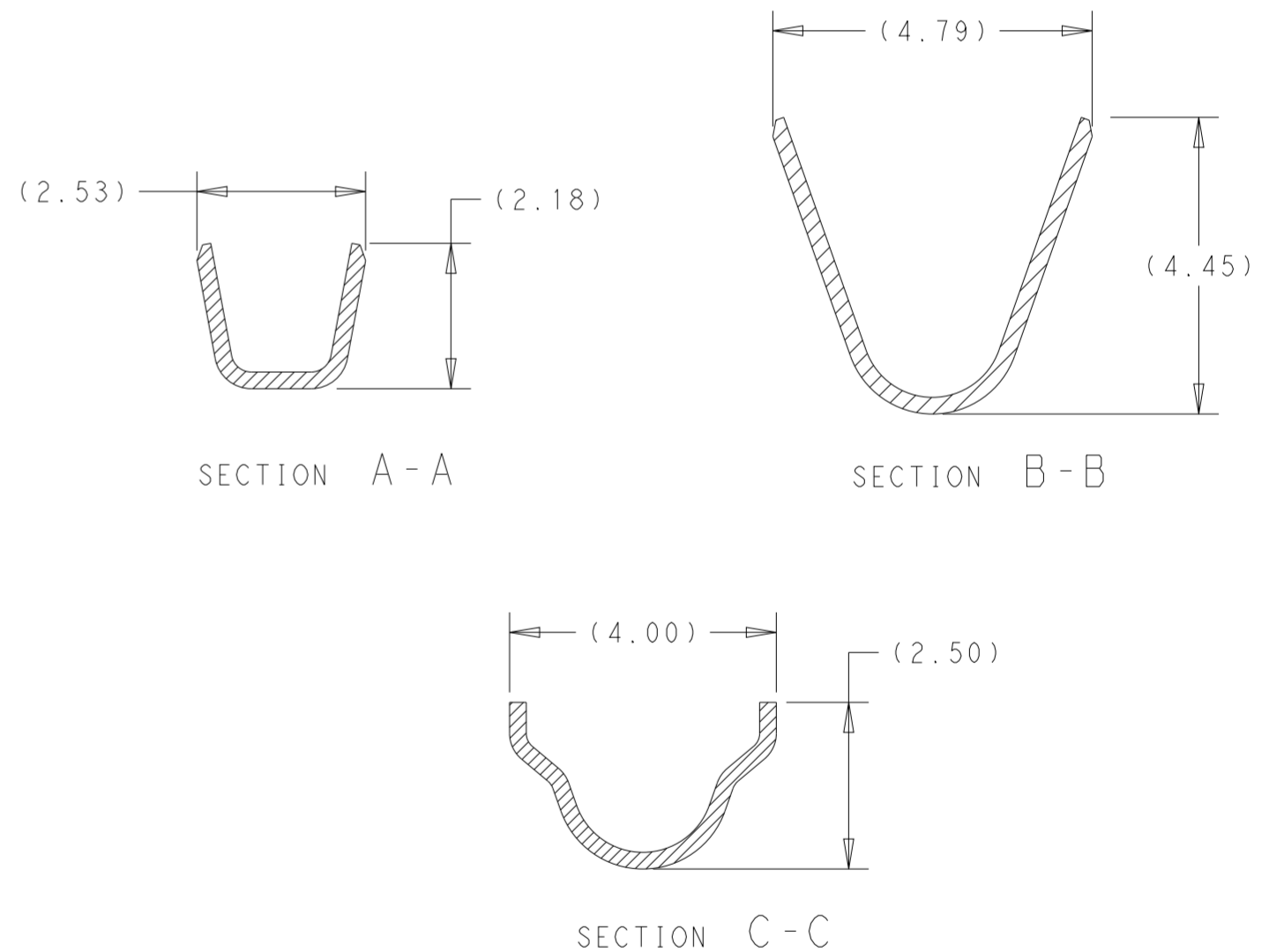
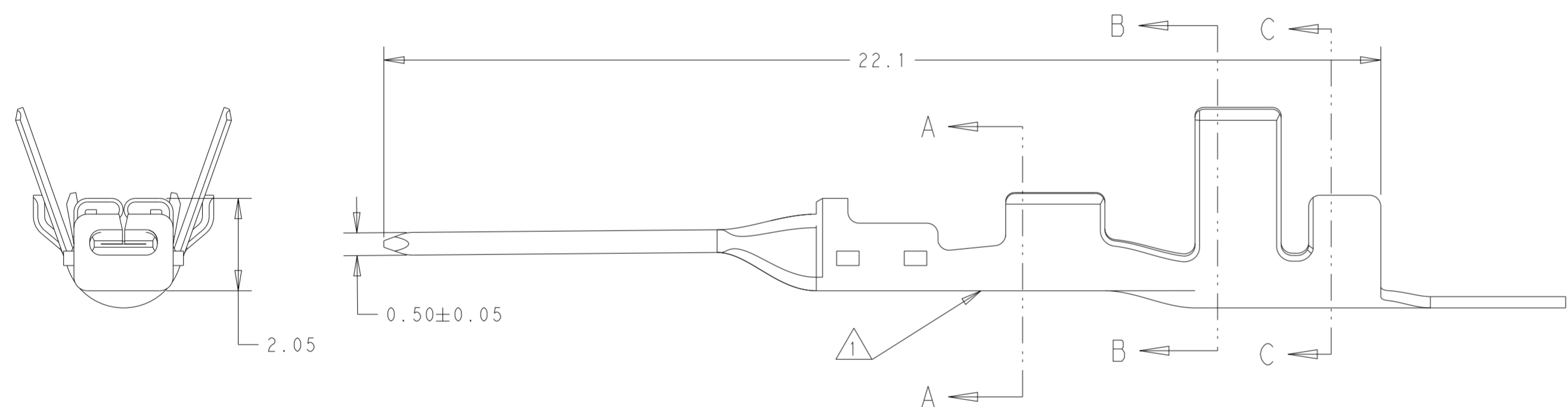

M1	BRASS	STANDARD TEMP. (105°C)	2329906-1
MATERIAL MARK 1	MATERIAL	TEMPERATURE RATING	PART NUMBER
THIS DRAWING IS A CONTROLLED DOCUMENT.		DWN 26MAR2018 CHK BASAVARAJA D A S. FERNANDES APVD C.YI 26MAR2018	TE Connectivity NAME POWER VERSA-LOCK TAB TERMINAL UNSEALED 18-20 AWG, 2x22 AWG
DIMENSIONS: mm	TOLERANCES UNLESS OTHERWISE SPECIFIED: 0 PLC ± 1 PLC ±0.40 2 PLC ±0.30 3 PLC ± 4 PLC ± ANGLES ±3° FINISH	PRODUCT SPEC 108-143081 APPLICATION SPEC 114-143082	
MATERIAL SEE TABLE	PRE-PLATED Sn	WEIGHT -	SIZE A2 CAGE CODE - DRAWING NO C-2329906 RESTRICTED TO - SCALE 10:1 SHEET 1 OF 1 REV B