

RECOMMENDED PANEL CUTOUT  
MAX. PANEL THICKNESS 4mm

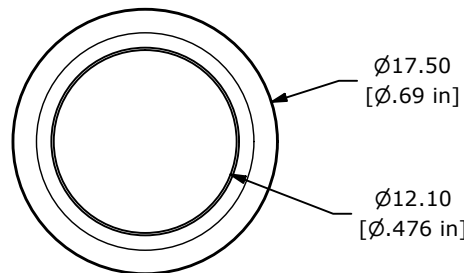

SWITCH FUNCTION	
POS. 1	POS. 2
OFF	(ON)
OPEN	1-2

(ON) = MOMENTARY

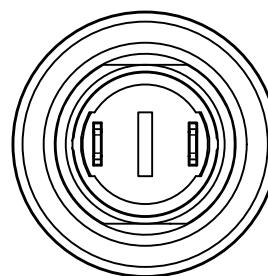
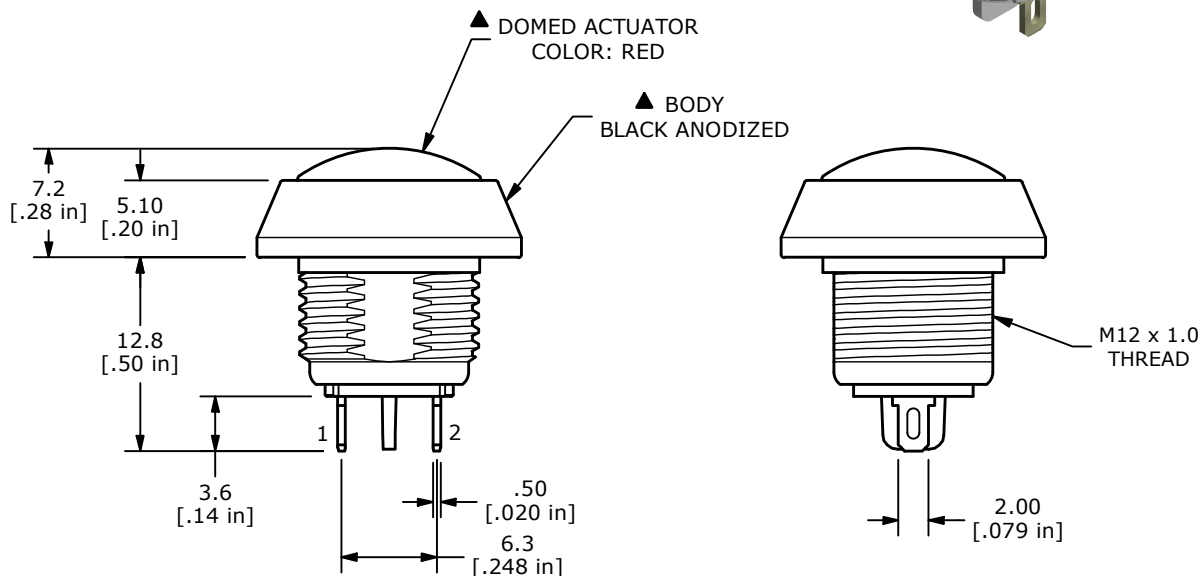
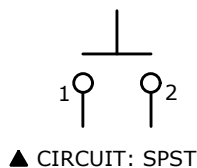

- NOTE:
- ALL DIMENSIONS IN MM [INCH]
  - GENERAL TOLERANCE: X.X = ±0.4  
X.XX = ±0.25
  - TERMINAL NUMBERS FOR REF ONLY
  - CONTACT MATERIAL: SILVER
  - RATING: 2A @ 36VDC
  - ELECTRICAL LIFE: 200,000 CYCLES
  - CONTACT RESISTANCE: 50 mΩ MAX. @ 1A 12VDC (INITIAL)
  - INSULATION RESISTANCE: 1,000 MΩ MIN. @ 500VDC
  - DIELECTRIC STRENGTH: 2,000 VAC rms.
  - OPERATING TEMPERATURE: -40°C to +85°C
  - PANEL THICKNESS MAX: 4.0mm
  - INGRESS PROTECTION: IP65
  - ▲ DENOTES CRITICAL PARAMETER.
  - HARDWARE INCLUDED: O-RING and HEXNUT (NOT SHOWN)

REV	ECO NO	DESCRIPTION	DATE	BY	E-SWITCH®			OBJECT ID	
C	ECO-103053	Print update	11/12/24	MW				000002799	
					TITLE PV5S24019				
					SCALE 2:1	DATE 12/3/2012	DR EDP	DWG 52-PV5S24019	REV C

THE INFORMATION CONTAINED IN THIS DOCUMENT IS PROPRIETARY TO E-SWITCH AND IS NOT TO BE COPIED OR TRANSFERRED