

SWITCH FUNCTION	
POS. 1	POS. 2
OFF	(ON)
None	1-2

() = MOMENTARY

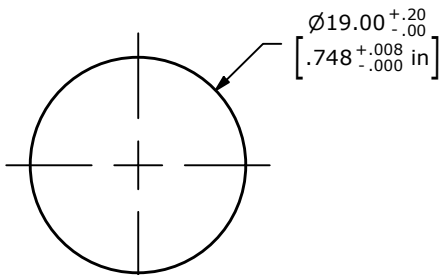
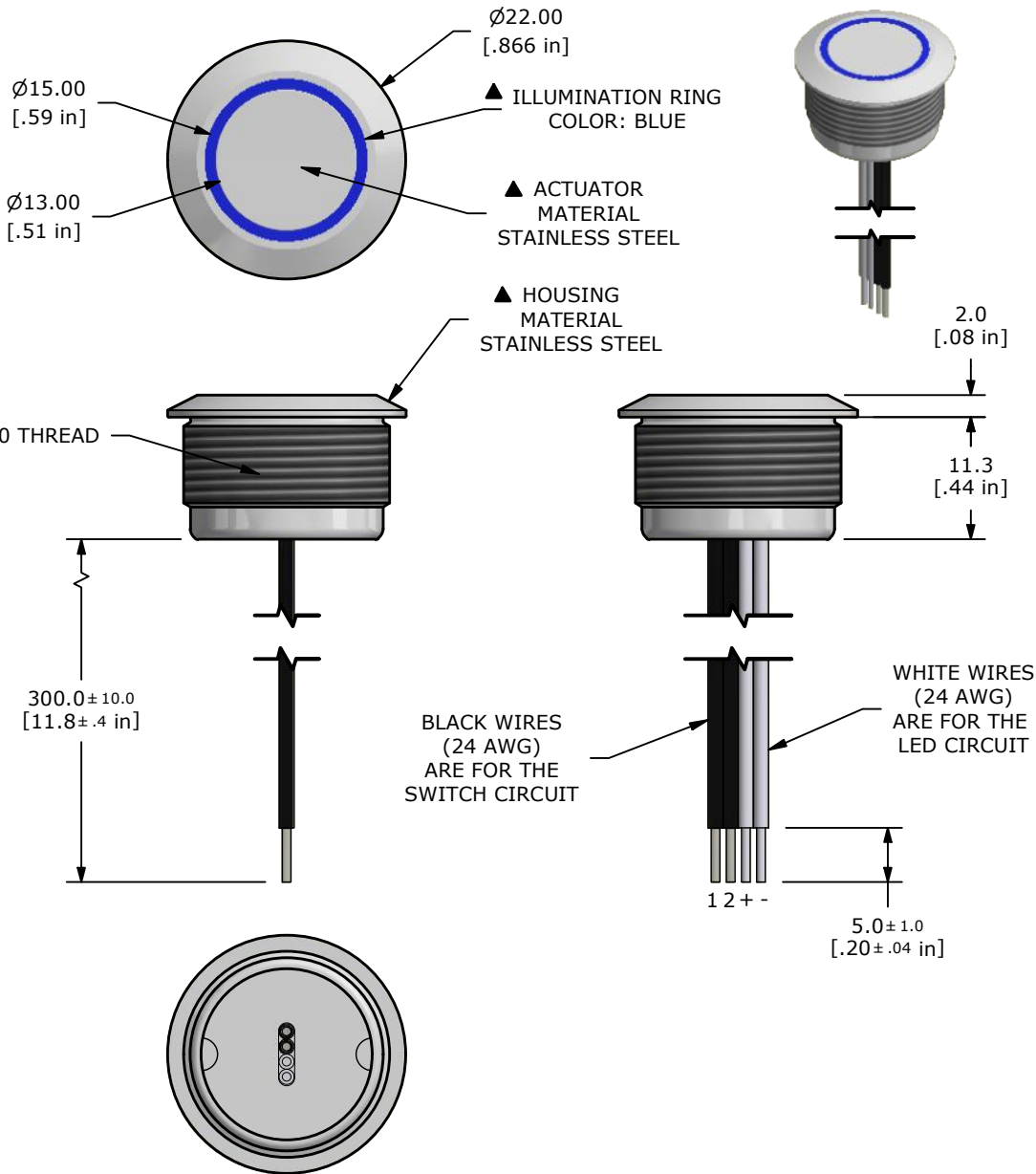

RECOMMENDED PANEL CUTOUT
PANEL THICKNESS 1 - 5mm

- NOTE:
1. ALL DIMENSIONS IN MM [INCH]
 2. GENERAL TOLERANCE: X.X = ±0.4
X.XX = ±0.25
 3. TERMINAL NUMBERS FOR REF ONLY
 4. CONTACT MATERIAL: Silver
 5. RATING: 50mA 24VDC
 6. ELECTRIC LIFE: 500,000 MAKE-AND-BREAK CYCLES AT FULL LOAD.
 7. INSULATION RESISTANCE: 1000 MΩ MIN.
 8. DIELECTRIC STRENGTH: 250 VAC MIN. FOR 1 MINUTE
 9. CONTACT RESISTANCE: 100mΩ MAX.
 10. OPERATING TEMP.: -25°C to +55°C
 11. TRAVEL: 0.5mm
 12. ▲ DENOTES CRITICAL PARAMETER.
 13. INGRESS PROTECTION: IP65
 - ▲14. LED VOLTAGE: 2.8V
 15. HARDWARE SUPPLIED: O-RING AND HEXNUT

D	24568	Housing Update	10/27/20	JM
C	23579	add (24 AWG) to wire callouts	9/25/18	MW
B	23411	add M19 x 1.0 thread callout	6/29/18	MW
A	23271	New Release	3/19/2018	RC
REV	PCR NO	DESCRIPTION	DATE	BY



TITLE PVT4FW4SS341				
SCALE	DATE	DR	DWG	REV
3:2	3/19/2018	RC	52-PVT4FW4SS341	D