

## 1500 Series - Barrier Terminal Blocks



1512 STD

### Specifications

- 75 amps
- 600 volts AC/DC
- Base, phenolic, 150°C (UL RTI)
- Screws, #10-32 phil-slot, brass, nickel plated
- Connector, brass, nickel plated
- 5/8" (.625") line-to-line spacing
- Bare wire range #10-22 AWG CU
- Accepts lugs w/max width of .50"

### Standards

- UL recognized file no. XCFR2.E62806
- CSA certified file no. LR19766
- CE (Component IEC 60947-7-1)
- RoHS compliant

### HEAVY DUTY Terminal Blocks- 1500 Series (Barrier Type)

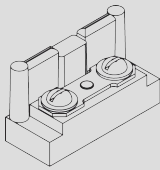
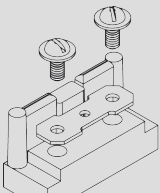
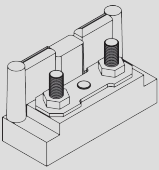
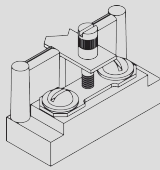
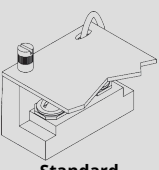
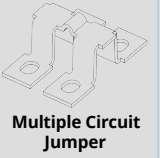
Poles (X)	Dimensions		 Standard connector with serrations for anti-rotation <a href="#">Datasheet</a>	 Removable connector with brass insert <a href="#">Datasheet</a>	 10-32 stud, removable connector <a href="#">Datasheet</a>	 Short circuiting bar with brass insert, 4 shorting pins per block <a href="#">Datasheet</a>	 Standard connector with hinge cover <a href="#">Datasheet</a>	 Multiple Circuit Jumper	Covers	
	A	B							Clear	White
2	2.00	1.62	1502STD	1502DJ	1502ST	1502SC	1502H	1502MCJ	CC1502	CW1502
4	3.25	2.88	1504STD	1504DJ	1504ST	1504SC	1504H	1504MCJ	CC1504	CW1504
6	4.50	4.12	1506STD	1506DJ	1506ST	1506SC	1506H	1506MCJ	CC1506	CW1506
8	5.75	5.38	1508STD	1508DJ	1508ST	1508SC	1508H	1508MCJ	CC1508	CW1508
12	8.25	7.88	1512STD	1512DJ	1512ST	1512SC	1512H	1512MCJ	CC1512	CW1512

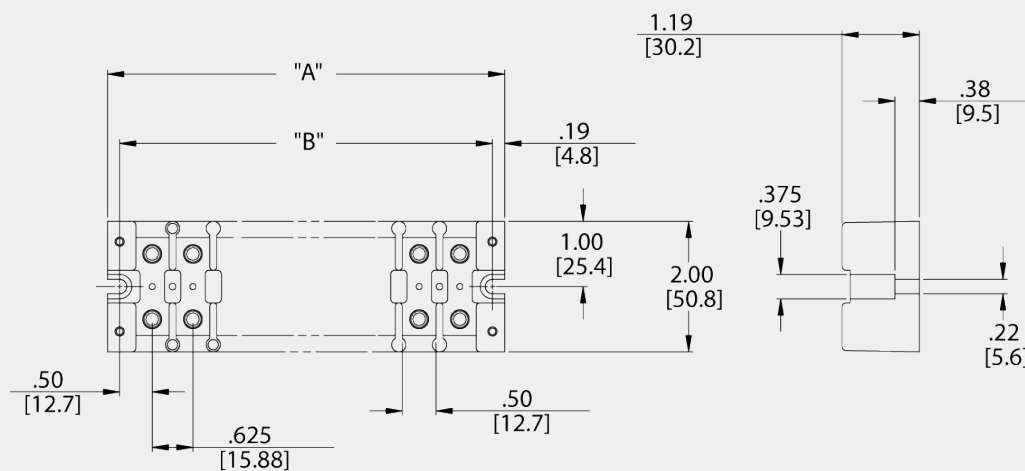

#### CONTACT

Marathon Special Products  
427 Van Camp Road  
P.O. Box 468  
Bowling Green, Ohio 43402

#### LINKS

- [About Us](#)
- [Contact Us](#)
- [Terms & Conditions](#)

#### ABOUT

Marathon Special Products is an industry leader for supplying power blocks, terminal blocks, and fuse holders in North America. We've achieved this by providing one of the broadest line offerings with various sizes, terminal styles, electrical ratings and features.

tel: 419-352-8441  
fax: 419-352-0875  
email: [marketing@marathonsp.com](mailto:marketing@marathonsp.com)

**Locate a Distributor**



**CUSTOMER SERVICE HOURS**

Mon-Fri 8am-5pm EST