

LTR	REVISION	DATE	APPD
A	040925-HF01: UPDATED PATTERN ON LENS 021624-GZ01: REMOVED RoHS COMPLIANT LOGO 092923-GZ01: REMOVED CRIMP O.D. TO ROUND & UPDATED DIMENSIONS	04-09-25	HF

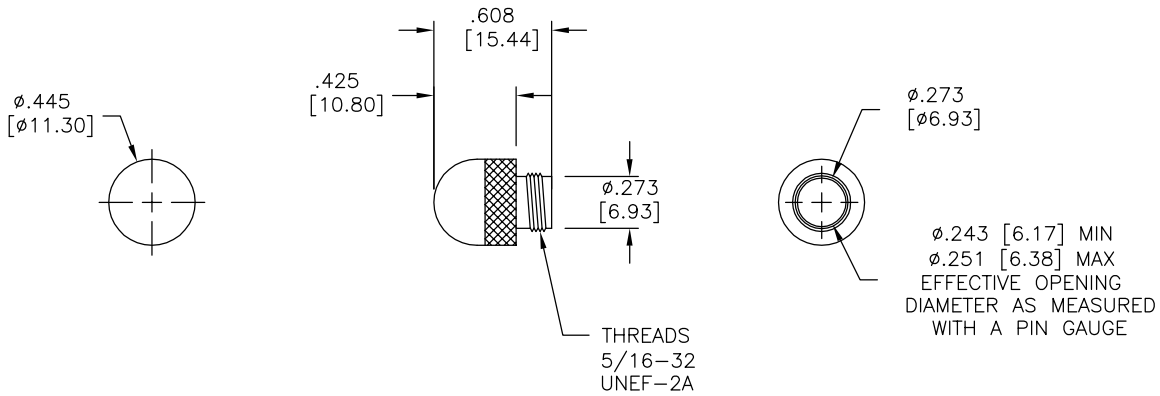

NOTES:

1. ALL DIMENSIONS ARE IN INCHES (MILLIMETERS).
2. LENS MEETS MIL SPEC MIL-L-3661.
3. LENS IS HIGH IMPACT PLASTIC.

LEDTRONICS PART NO.	COLOR
LENS-LCD470-CA	CLEAR AMBER
LENS-LCD470-CG	CLEAR GREEN
LENS-LCD470-CR	CLEAR RED
LENS-LCD470-CW	CLEAR WATER
LENS-LCD470-CY	CLEAR YELLOW
LENS-LCD470-DA	DIFFUSED AMBER
LENS-LCD470-DG	DIFFUSED GREEN
LENS-LCD470-DR	DIFFUSED RED
LENS-LCD470-DW	DIFFUSED WHITE
LENS-LCD470-TW	CLOUDY CLEAR

REVISION NOTIFICATION
<input type="checkbox"/> DLC
<input type="checkbox"/> UL/ETL
<input type="checkbox"/> MADE IN USA
<input type="checkbox"/> CUSTOMER _____
<input type="checkbox"/> OTHER
REDLINE CHECKLIST
<input type="checkbox"/> REDLINE(YES)
<input type="checkbox"/> DATE: _____
<input type="checkbox"/> INITIATED BY: _____
<input type="checkbox"/> ECR REQUIRED YES <input type="checkbox"/> NO <input type="checkbox"/>
<input type="checkbox"/> WORK ORDER# _____

LED[®]
LEDTRONICS,™ INC.
 23105 KASHIWA COURT
 TORRANCE, CA 90505

-PROPRIETARY-
 This document contains Proprietary information of LEDTRONICS, INC. It may not be copied, used or disclosed for any purpose without the prior express written consent of LEDTRONICS, INC.

.XXX ± .010 TOLERANCE PER ANSI-Y14.5
 .XX ± .025 (UNLESS OTHERWISE STATED)
 ANGLES ± 0°,30'
 FRACT. ± 1/32

TITLE					
LENS-LCD470-XX					
DWG NO	SCALE	SHEET	DATE		
CMLN0070-CUST	1:1	1 OF 1	03-18-20		
CODE IDENT NO.	DWG BY	CHK BY	QA	MFG	R&D
8Z410	HF 03-18-20		RR 04-11-25	PP 04-11-25	UF 04-11-25